



# HEART *of* TEXAS

## LEATHER SHOW

August 6<sup>th</sup>  
**FRIDAY**

August 7<sup>th</sup>  
**SATURDAY**

August 8<sup>th</sup>  
**SUNDAY**

Workshops Start Aug. 3<sup>rd</sup>

Hosted by:  
Leather Crafters  
& Saddlers Journal



Belt by Don Gonzales

  
WACO CONVENTION CENTER  
100 Washington Ave, Waco, TX 76701

# WACO, TEXAS

# Table of Contents

3	Trade Show Location & Information
4	Map of Waco
5	Leather Week Schedule
6-7	Waco Convention Center Floor Plan
9	Weaver Leather Supply Leather Carving Contest
10	List of Workshops by Instructor
11	List of Workshops by Subject
12	Heart of Texas Reception
13	Workshop Timetable
14	Workshop Policies & Tips
17-43	Workshop Descriptions (alpha by Title)
44-45	Workshop Project Photos
48-50	Workshop Instructors
51-52	Registration Form and Payment

---

TRADE SHOW & WORKSHOPS HOSTED BY:

## LEATHER CRAFTERS & SADDLERS JOURNAL

For information, call: 888•289•6409  
[www.LeanerCraftersJournal.com](http://www.LeanerCraftersJournal.com)

---

HOST HOTEL:

**Hilton**

**HILTON WACO**

(next to the convention center)

113 S University Parks Dr, Waco, TX 76701

\$149/night + tax

Group Code: HOT

(254) 754-8484



**HEART of TEXAS**  
LEATHER SHOW

Friday, Aug. 6<sup>th</sup> 9 a.m. - 6 p.m.

Saturday, Aug. 7<sup>th</sup> 9 a.m. - 5 p.m.

Sunday, Aug. 8<sup>th</sup> 9 a.m. - 2 p.m.

**FREE ADMISSION TO  
THE SHOW**



**WACO CONVENTION CENTER**

100 WASHINGTON AVE

WACO TX 76701

## **BRAZOS BALLROOM**

**INFORMATION:** DVDs, Books, Catalogs, Patterns

**LACE:** Many Colors, Various Widths

**LEATHERS:** Skirting, Tooling, Garment,  
Boot/Shoe, Upholstery, Rawhide

**MACHINERY:** Sewing Machines, Skivers, Strap Cutters

**SADDLERY:** Trees, Hardware, Tack

**SILVER:** Conchos, Jewelry

**TOOLS:** New & Vintage, Specialty, Swivel Knives,  
Stamping, Skiving, Mallets

**TOPICALS:** Paints, Dyes, Finishes, Leather Care

**AND MORE!**



# LEATHER WEEK SCHEDULE



## HEART *of* TEXAS LEATHER SHOW

Tuesday, Aug. 3<sup>rd</sup>

Workshops

---

Wednesday, Aug. 4<sup>th</sup>

Workshops

---

Thursday, Aug. 5<sup>th</sup>

Workshops  
**TRADE SHOW SET-UP**  
**HEART OF TEXAS RECEPTION**

---

Friday, Aug. 6<sup>th</sup>

Workshops  
**TRADE SHOW**

---

Saturday, Aug. 7<sup>th</sup>

Workshops  
**TRADE SHOW**

---

Sunday, Aug. 8<sup>th</sup>

**TRADE SHOW**

**UPPER LEVEL**

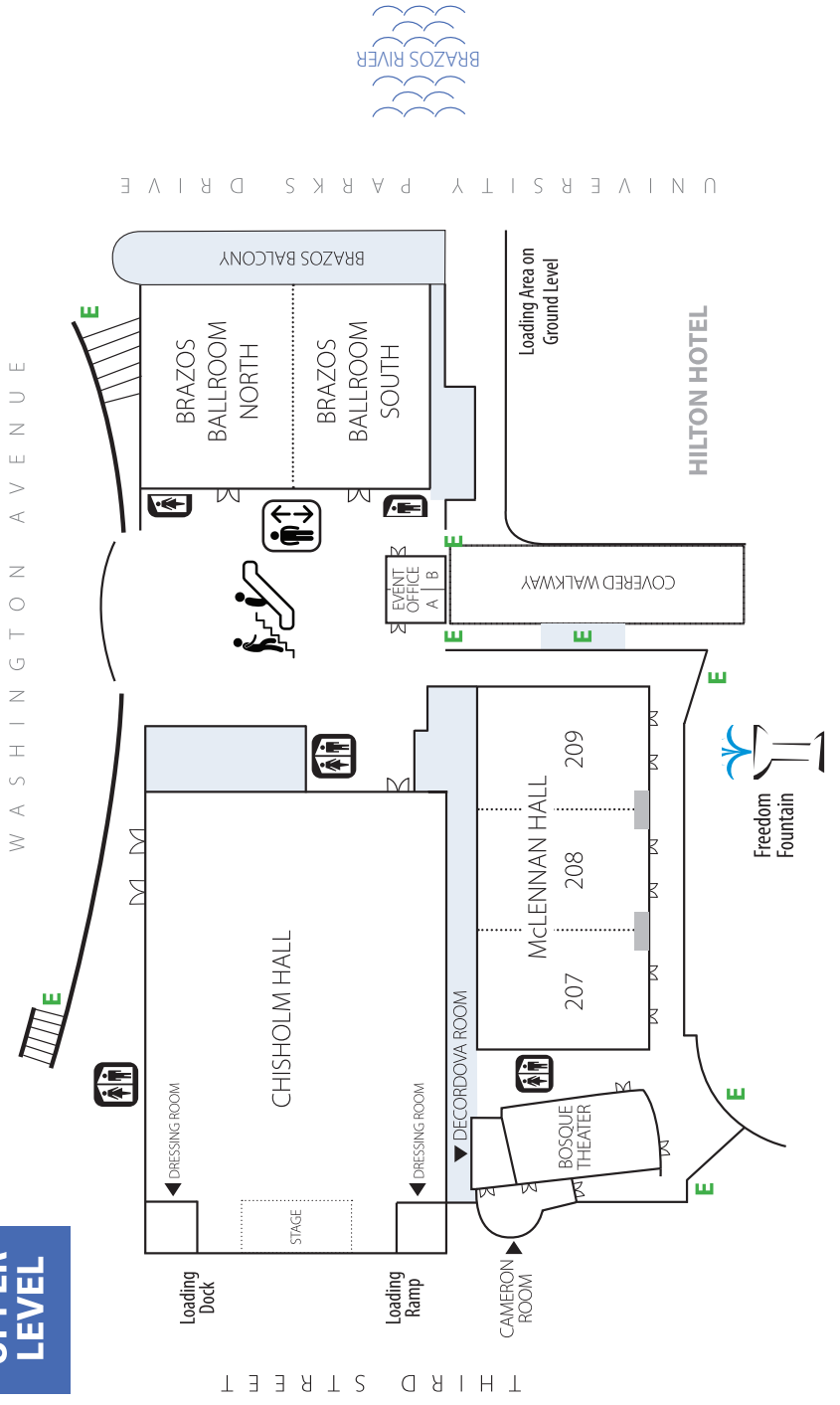

UNIVERSITY PARKS DRIVE

WASHINGTON AVENUE

HILTON HOTEL

FRANKLIN AVENUE

THIRD STREET

**LOWER LEVEL**

WASHINGTON AVENUE

COVERED DRIVE

THIRD STREET

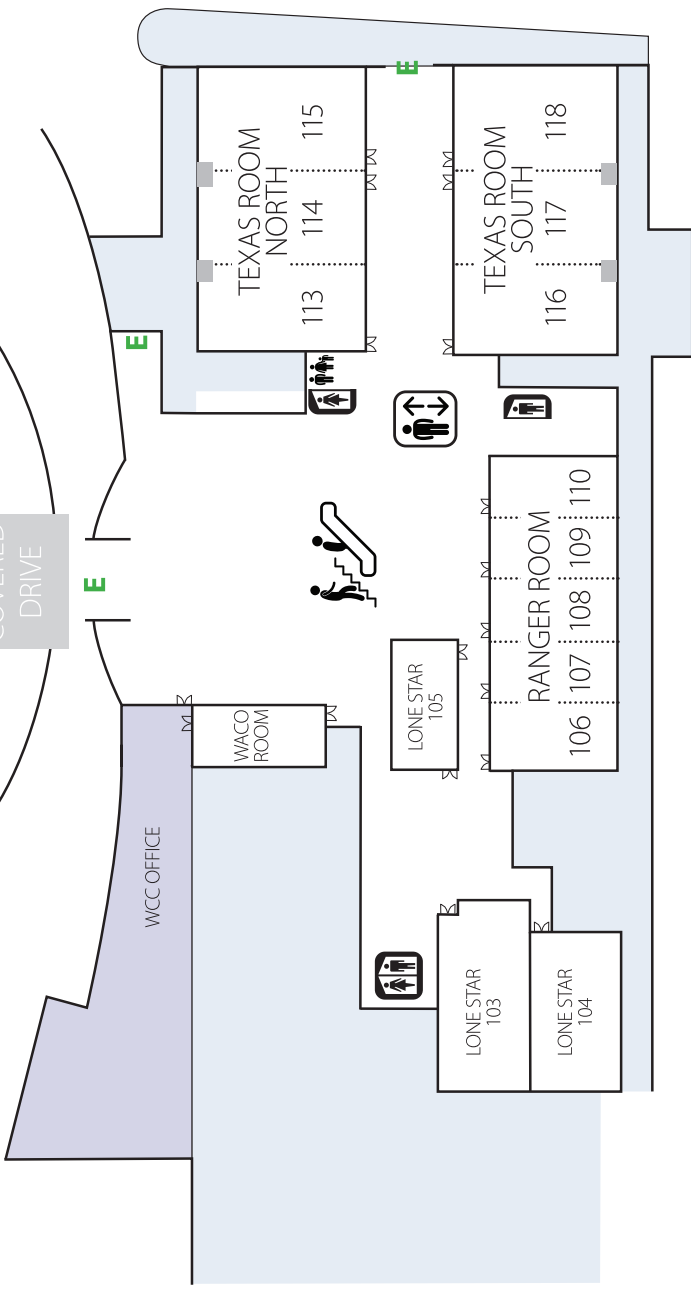

UNIVERSITY PARKS DRIVE



A virtual tour of the Waco Convention Center is available at [WacoCC.com](http://WacoCC.com).



**WEAVER**<sup>TM</sup>  
LEATHER SUPPLY

## QUALITY 45 YEARS STRONG

You'll find the right supplies for all your projects with Weaver Leather Supply. Over 45 years of manufacturing experience goes into hand selecting the finest leather, webbing, hardware, tools, saddlery supplies, leather care, machinery and more to ensure successful results for professionals and hobbyists alike.

Wholesale: [shop.weaverleather.com](http://shop.weaverleather.com) Retail: [weaverleathersupply.com](http://weaverleathersupply.com) 800-932-8371

20 Leather Carving Contest 21  
Title Sponsor



# 20 Leather Carving Contest 21

## General

**Pictorial/Figure**

**1<sup>st</sup> Place - \$150**

**Carving/Stamping**

**1<sup>st</sup> Place - \$150**

and

## Expert

**Pictorial/Figure**

**1<sup>st</sup> Place - \$250**

**Carving/Stamping**

**1<sup>st</sup> Place - \$250**

A finished piece of leatherwork 7 inches (17.75 cm) by 9 inches (22.75 cm), portrait or landscape. The artist chooses the category that their work will be judged in.

The Judges reserve the right to move an artwork into the classification they feel best represents the artwork entered.

\$10 to enter; return shipping extra.

Artwork check-in: Thursday, August 5<sup>th</sup>, 12pm-5pm at the Trade Show Registration Booth/Ticket Office in the Waco Convention Center. Artwork can also be mailed to arrive between 08/02/21 and 08/05/21. All artwork must be received by Thursday, August 5<sup>th</sup> at 5pm.

Send artwork to: Waco Convention Center  
c/o Leather Trade Show/Ticket Office  
100 Washington Ave  
Waco, TX 76701

Artworks will be displayed at the Heart of Texas Leather Trade Show August 6<sup>th</sup>- 8<sup>th</sup> 2021.

*Sponsored exclusively by:*  
**Weaver Leather Supply**

*Contest Judged by: Don Gonzales, Terry Henson & Takeshi Yonezawa*  
*Administered by: Leather Crafters & Saddlers Journal*

INSTRUCTOR	WORKSHOP	PG	DAY	TIME	PRICE
Andre	Slickbald's Advanced Carving Techniques	39	THU	8 am - 5 pm	\$165
Andre	Slickbald's Belt Basics	40	WED	7 pm - 10 pm	\$85
Andre	Slickbald's Concealed Carry Gunleather	40	FRI	8 am - 5 pm	\$200
Andre	Slickbald's Cowboy Action Gunleather	41	SAT	8 am - 5 pm	\$200
Andre	Slickbald's Demystifying the Stitcher	41	SUN	8 am - 11 am	\$85
Andre/Beard	Slickbald & Beard's Framed Picture (Combo)	38	WED-THU	8 am - 5 pm	\$300
Baugher	Chinks 101	22	TUE	1 pm - 5 pm	\$175
Baugher	Chinks 102	22	WED	1 pm - 5 pm	\$175
Baugher	Shotgun Chaps Pattern Drafting	37	THU	1 pm - 5 pm	\$175
Bernier	Leather Tree Diorama	28	FRI-SAT	9 am - 5 pm	\$250
Brenner	Pricing Your Work	31	SAT	8 am - 12 pm	\$95
Dorsett	Common & Creative Closures	22	FRI	1 pm - 5 pm	\$85
Gonzales	Repeating (Belt) Design	32	THU	9 am - 3 pm	\$165
Gould	Floral Pattern Layout	28	SAT	8 am - 12 pm	\$85
Gould	Saddle Solutions: All 4 Saddle Workshops	34	THU-FRI	8 am - 5 pm	\$400
Gould	Saddles - Part 1: Ground Seat	34	THU	8 am - 12 pm	\$125
Gould	Saddles - Part 2: Saddle Fit Up	34	THU	1 pm - 5 pm	\$125
Gould	Saddles - Part 3: Front	35	FRI	8 am - 12 pm	\$125
Gould	Saddles - Part 4: Cattle Binding	35	FRI	1 pm - 5 pm	\$125
Gould	Swivel Knife Finesse	42	SAT	1 pm - 5 pm	\$95
Heizer	The "Sarge" (choose Tuesday or Wednesday)	42	TUE/WED	8 am - 5 pm	\$250
King	Precision Stamping with Barry King	31	THU	8 am - 12 pm	\$95
Klenda	Chap & Chink Making: An Overview	20	FRI	7 pm - 9:30 pm	\$85
Klenda	Cowboy Cuffs	24	THU	8 am - 5 pm	\$175
Klenda	Leatherwork Personal Training	30	SAT	1 pm or 3 pm	\$100
Klenda	Let's Make Saddle Bags!	30	TUE-WED	8 am - 5 pm	\$345
Lee	Leather FUNdamentals	28	THU	9 am - 5 pm	\$165
Lee	Roll the Dice!	32	SAT	9 am - 5 pm	\$185
Libertini	Sculpted 3-D Magnolia	35	FRI	9 am - 5 pm	\$165
Libertini	Tooling Realistic Portraits: Sitting Bull	43	SAT	9 am - 5 pm	\$165
Magnus	DIY Marketing: Sell More Stuff	24	FRI	7 pm - 10 pm	\$85
Miller	Modifying Your Old Stamps	30	WED	7 pm - 10 pm	\$85
Park	Bobby Park's Advanced Floral Tooling	17	WED	9 am - 4 pm	\$165
Park	Bobby Park's Antiquing, Dyeing & Finishing Demonstration	18	TUE	7 pm - 10 pm	\$85
Park	Bobby Park's Burnishing Edges Demonstration	18	THU	9 am - 12 pm	\$85
Park	Bobby Park's Creating Western Floral Designs	19	TUE	9 am - 4 pm	\$165
Park	Bobby Park's Inlays & Filligree	19	THU	1 pm - 4 pm	\$85
Park	Bobby Park's Sharpening Your Bench Tools	20	WED	7 pm - 10 pm	\$85
Sartor	Silver Creek Leather's Introduction to Leathercraft for Youth	37	SAT	9 am - 12 pm	Free
Sartor	Silver Creek Leather's Workshop for Veterans	37	SUN	9 am - 12 pm	Free
Sedberry	Airbrushing Dye on Leather	17	WED	9 am - 5 pm	\$280
Sorrell	Fitting & Choosing a Last	25	FRI	8 am - 12 pm	\$120
Yonezawa	Fine Assembly Work	25	FRI	8 am - 5 pm	\$185

SUBJECT	WORKSHOP	INSTRUCTOR	PG	DAY	PRICE
Beginner	Leather FUNdamentals	Lee	28	THU	\$165
Beginner	Silver Creek Leather's Introduction to Leathercraft for Youth	Sartor	37	SAT	Free
Beginner	Silver Creek Leather's Workshop for Veterans	Sartor	37	SUN	Free
Boots	Fitting & Choosing a Last	Sorrell	25	FRI	\$120
Business	DIY Marketing: Sell More Stuff	Magnus	24	FRI	\$85
Business	Pricing Your Work	Brenner	31	SAT	\$95
Chap & Chink	Chap & Chink Making: An Overview	Klenda	20	FRI	\$85
Chaps	Shotgun Chaps Pattern Drafting	Baughner	37	THU	\$175
Chinks	Chinks 101	Baughner	22	TUE	\$175
Chinks	Chinks 102	Baughner	22	WED	\$175
Coloring	Airbrushing Dye on Leather	Sedberry	17	WED	\$280
Construction	Slickbald's Belt Basics	Andre	40	WED	\$85
Construction	Common & Creative Closures	Dorsett	22	FRI	\$85
Construction	The "Sarge" (choose Tuesday or Wednesday)	Heizer	42	TUE/WED	\$250
Construction	Cowboy Cuffs	Klenda	24	THU	\$175
Construction	Let's Make Saddle Bags!	Klenda	30	TUE-WED	\$345
Construction	Roll the Dice!	Lee	32	SAT	\$185
Construction	Fine Assembly Work	Yonezawa	25	FRI	\$185
Figure Carving	Tooling Realistic Portraits: Sitting Bull	Libertini	43	SAT	\$165
Filligree	Bobby Park's Inlays & Filligree	Park	19	THU	\$85
Finishing	Bobby Park's Antiquing, Dyeing & Finishing Demonstration	Park	18	TUE	\$85
Finishing	Bobby Park's Burnishing Edges Demonstration	Park	18	THU	\$85
Floral	Floral Pattern Layout	Gould	28	SAT	\$85
Floral	Bobby Park's Advanced Floral Tooling	Park	17	WED	\$165
Floral	Bobby Park's Creating Western Floral Designs	Park	19	TUE	\$165
Floral/3-D	Slickbald & Beard's Framed Picture (Combo)	Andre/Beard	38	WED-THU	\$300
Gunleather	Slickbald's Concealed Carry Gunleather	Andre	40	FRI	\$200
Gunleather	Slickbald's Cowboy Action Gunleather	Andre	41	SAT	\$200
Leather Sculpting	Leather Tree Diorama	Bernier	28	FRI-SAT	\$250
Leather Sculpting	Sculpted 3-D Magnolia	Libertini	35	FRI	\$165
Miscellaneous	Modifying Your Old Stamps	Miller	30	WED	\$85
Personal Training	Leatherwork Personal Training	Klenda	30	SAT	\$100
Saddle	Saddle Solutions: All 4 Saddle Workshops	Gould	34	THU-FRI	\$400
Saddle	Saddles - Part 1: Ground Seat	Gould	34	THU	\$125
Saddle	Saddles - Part 2: Saddle Fit Up	Gould	34	THU	\$125
Saddle	Saddles - Part 3: Front	Gould	35	FRI	\$125
Saddle	Saddles - Part 4: Cattle Binding	Gould	35	FRI	\$125
Sewing	Slickbald's Demystifying the Stitcher	Andre	41	SUN	\$85
Sharpening	Bobby Park's Sharpening Your Bench Tools	Park	20	WED	\$85
Stamping	Repeating (Belt) Design	Gonzales	32	THU	\$165
Stamping	Precision Stamping with Barry King	King	31	THU	\$95
Swivel Knife	Slickbald's Advanced Carving Techniques	Andre	39	THU	\$165
Swivel Knife	Swivel Knife Finesse	Gould	42	FRI	\$95

# HEART *of* TEXAS RECEPTION

*Thursday August 5<sup>th</sup>*  
*5:30PM to 10PM*



JAMES A. EDMOND POST 121  
722 LEROY PKWY, ELM MOTT, TX 76640

Complimentary

*BBQ Ribs & Brisket*

*Drinks*

*Shuttle*



Waco Convention Center

Reception



Hermann Oak Leather Company

Horse Shoe Brand Tools

Leather Machine Company LLC

Sponsored by:

Leather Crafters & Saddlers Journal

Makers Leather Supply

Tandy Leather

The Fiebing Company

# WORKSHOP TIMETABLE

	Ranger 106	Ranger 107	Ranger 108	Ranger 109	Ranger 110	Lone Star 104	Lone Star 105	TX South 118
<b>8/3 TUE am</b>	Let's Make Saddle Bags <i>Klenda</i>		Bobby Park's Creating Western Floral Des.	The "Sarge" Heizer	The "Sarge" Heizer			
<b>8/3 TUE pm</b>	Let's Make Saddle Bags <i>Klenda</i>	Chinks 101 <i>Baughner</i>	Bobby Park's Creating Western Floral Des.	The "Sarge" Heizer	The "Sarge" Heizer			
<b>8/3 TUE -eve-</b>			Bobby Park's Antiquing, Dyeing, & Finishing					
<b>8/4 WED am</b>	Let's Make Saddle Bags <i>Klenda</i>		Bobby Park's Advanced Floral Tooling	The "Sarge" Heizer	The "Sarge" Heizer	Slickbald & Beard's Framed Picture <i>Andre-day1</i>		
<b>8/4 WED pm</b>	Let's Make Saddle Bags <i>Klenda</i>	Chinks 102 <i>Baughner</i>	Bobby Park's Advanced Floral Tooling	The "Sarge" Heizer	The "Sarge" Heizer	Slickbald & Beard's Framed Picture <i>Andre-day 1</i>		
<b>8/4 WED -eve-</b>		Modifying Your Old Stamps <i>Miller</i>	Bobby Park's Sharpening Your Bench Tools			Slickbald's Belt Basics <i>Andre</i>		
<b>8/5 THU am</b>	Cowboy Cuffs <i>Klenda</i>	Precision Stamping with Barry King <i>King</i>	Bobby Park's Burnishing Edges	Saddles – Part 1: Ground Seat <i>Gould</i>	Slickbald & Beard's Framed Picture <i>Beard-day2</i>	Slickbald's Advanced Carving Techniques <i>Andre</i>	Leather FUN-damentals <i>Lee</i>	Repeating (Belt) Design <i>Gonzales</i>
<b>8/5 THU pm</b>	Cowboy Cuffs <i>Klenda</i>	Shotgun Chaps Pattern Drafting <i>Baughner</i>	Bobby Park's Inlays & Filligree	Saddles – Part 2: Saddle Fit Up <i>Gould</i>	Slickbald & Beard's Framed Picture <i>Beard-day2</i>	Slickbald's Advanced Carving Techniques <i>Andre</i>	Leather FUN-damentals <i>Lee</i>	Repeating (Belt) Design <i>Gonzales</i>
<b>8/6 FRI am</b>	Fitting & Choosing a Last <i>Sorrell</i>	Sculpted 3D Magnolia <i>Libertini</i>	Leather Tree Diorama <i>Bernier</i>	Saddles – Part 3: Front <i>Gould</i>	Fine Assembly Work <i>Yonezawa</i>	Slickbald's Concealed Carry Gunleather <i>Andre</i>		<b>Footwear Makers Symposium</b>
<b>8/6 FRI pm</b>	Common & Creative Closures <i>Dorsett</i>	Sculpted 3D Magnolia <i>Libertini</i>	Leather Tree Diorama <i>Bernier</i>	Saddles – Part 4: Cante Binding <i>Gould</i>	Fine Assembly Work <i>Yonezawa</i>	Slickbald's Concealed Carry Gunleather <i>Andre</i>		<b>Footwear Makers Symposium</b>
<b>8/6 FRI -eve-</b>	Chap & Chink Making <i>Klenda</i>				DIY Marketing: Sell More Stuff <i>Magnus</i>			
<b>8/7 SAT am</b>	Pricing Your Work <i>Brenner</i>	Tooling Realistic Portraits: Sitting Bull <i>Libertini</i>	Leather Tree Diorama <i>Bernier</i>	Floral Pattern Layout/ <i>Gould</i>	SCL's Intro. to Leathercraft for Youths <i>Sartor</i>	Slickbald's Cowboy Action Gunleather <i>Andre</i>	Roll the Dice! <i>Lee</i>	
<b>8/7 SAT pm</b>	Leatherwork Personal Training <i>Klenda</i>	Tooling Realistic Portraits: Sitting Bull <i>Libertini</i>	Leather Tree Diorama <i>Bernier</i>	Swivel Knife Finesse/ <i>Gould</i>		Slickbald's Cowboy Action Gunleather <i>Andre</i>	Roll the Dice! <i>Lee</i>	
<b>8/8 SUN am</b>						Slickbald's Demystifying the Stitcher <i>Andre</i>	SCL's Leather-Workshop for Veterans <i>Sartor</i>	

**Airbrushing Dye on Leather** will be taught Wednesday at:

Maker's Leather Supply, 451 S McLennan Loop, Elm Mott, TX 76640.

## Workshop Registration is Easy!

Call: 888-289-6409 or 715-362-5393

Web: [www.leathercraftersjournal.com](http://www.leathercraftersjournal.com)

Mail: Fill out the registration (back cover) and mail it with payment to the *Journal*. Your registration is not official until payment is received in full.

### Cancellation Policy

- If you become ill, workshop registration fees will be refunded in full if canceled by July 31, 2021. After July 31, a credit will be applied to your account.



### Tips for Students:

- Sharpen your tools before each workshop
- Bring a light (ie: headlamp); Magnifying headlamps are available from our online store at [www.leathercraftersjournal.com](http://www.leathercraftersjournal.com)
- Make a traveling cutting/stamping board (Volume 23 No. 3 May/June 2013, p.63 "Have Board...Can Travel")



While attending the Heart of Texas Leather Trade Show and/or workshops, you will be exposed to **intellectual property**. Please observe the following protocols:

- Education session (workshop) recordings by any means (photographing, audiotaping, or videotaping) are strictly prohibited and may only be done with express written consent of the instructor, the Leather Crafters & Saddlers Journal (LCSJ), AND all workshop attendees/participants, except by (an) LCSJ-authorized agent(s) for LCSJ's purposes. The reproduction/distribution of video recording, audio recording, and/or any materials received from instructors is strictly prohibited without express written consent of the instructor and the LCSJ. In no way shall any intellectual property be copied or reproduced without express written consent of the instructor. Violators must either surrender their recordings or demonstrate that they have been deleted from all devices/locations. Committing additional infractions may result in the participant not be allowed to participate in the entire event and banned from future LCSJ events.
- Audiotaping/videotaping of the Heart of Texas Leather Trade Show is strictly prohibited. Photography of the exhibitors/exhibitor spaces and posting of the same to the Internet is allowed.
- Attending/visiting a workshop in which you are NOT registered is forbidden. This includes students in other workshops and other instructors. Interruptions detract from the learning experience of paying students and interrupt the flow of teaching as well. This includes "just popping by" to minutes-long visits. Under no circumstances shall any student be accompanied by a non-paying person without prior written consent from LCSJ\*.

In addition:

- Silence your phones while in workshops and refrain from wearing perfumes/cologne.
- Do not attend any part of the show if you are ill or within 24 hours of no longer feeling ill.

\*Students under 18 may be accompanied by a non-participatory adult.

SKIRTING • HARNESS • LATIGO • HOLSTER • RAWHIDE • TOOLING

## Hermann Oak Russet Skirting Leather

Carves Like Butter and Stamps to an Incredible Depth

The unique color, the way it oils so evenly, the clean flesh, firmness and its excellent yield give your work a uniqueness like no other. Our leather is crafted to last a lifetime. Your work of art will keep its body and beauty long after others sag and fade.

Hermann Oak Leather is the last of the Vegetable Tanners using the original traditional tanning methods. Made in the USA with US steer hides.

Portfolio Cover by Bobby Park



For wholesale service, call 800-325-7950, or call the dealer nearest to you.

Bowden Leather Company • El Paso, TX • 915-877-1557  
Goliger Leather Company • Ventura, CA • 800-423-2329  
Hide & Leather House, Inc. • Napa, CA • 707-255-6160  
Montana Leather Company • Billings, MT • 406-245-1660  
Oregon Leather Company • Portland, OR • 503-228-4105  
Panhandle Leather Company • Amarillo, TX • 806-373-0535  
Springfield Leather Co. • Springfield, MO • 800-668-8518  
Tandy Leather • Fort Worth, TX • 877-LEATHER  
Weaver Leather • Mt. Hope, OH • 800-WEAVER-1  
Birdsall Leather • Botany, NSW, Australia • 011-612-9316-6299  
Toowoomba Saddlery • Toowoomba, QLD, Australia • 011-617-4633-1855  
Buckskin Fur & Leather Co. • Calgary, Alberta, Canada • 888-723-0806  
Craft & Company Ltd. • Suginami-ku, Tokyo, Japan • 011-81-3-3393-2222  
Kyoshin Elle & Co., Ltd. • Taito-Ku, Tokyo, Japan • 011-81-3-3866-3221  
Star Trading Co. • Maniwa, Japan • 011-81-8-6742-8004  
Soft Art • Murrhardt, Germany • 011-49-7192-212-370



Hermann Oak Leather Co. • St. Louis, Missouri • USA  
Since 1881 • [www.hermannoakleather.com](http://www.hermannoakleather.com)

Official  
Workshop  
Sponsor



# Fiebing's

[www.fiebing.com](http://www.fiebing.com)

## Create. Color. Finish.

Whether it's cleaning, coloring or finishing, Fiebing's makes it easy for you to choose the right product for your leathercraft project.



Dyes & Stains



Edge Finishes



Antiques



Top Finishes



Prep





---

## Airbrushing Dye on Leather

### John Sedberry

Maker's Leather Supply, Shop

Wednesday 8/4 9:00am - 5:00pm

*All skill levels welcome!*

*Student Limit 6*

\$280.00

There is a great deal of mystery surrounding the use of an airbrush for leather, which airbrush to purchase, what dyes and paints can be used, what can an airbrush be used for, and how to properly use and maintain an airbrush. This workshop will deal with each of these issues, plus allow you to practice basic airbrush movements. You will learn how to create a coloring effect which some artists call a "sunburst". Lastly, we will complete a leather project that utilizes the sunburst technique. Tuition for this workshop is a bit higher due to the fact that each student will be provided with a NEW Harder & Steenbeck Ultra airbrush (made by the German company, Harder & Steenbeck, value \$90.00) to keep!

**Materials to Bring:** As there will be several persons concurrently using airbrushes in the workshop, it is highly recommended that each student purchase a reusable filtration breathing device (available from Amazon for about \$28.00). (Regular Kn95 masks and disposable gloves will be available; however, the filtration mask is recommended.) No additional tools are necessary.

**Materials for this workshop donated/provided by:**

Hermann Oak Leather Co., The Fiebing Company, Spray Gunner, Tandy Leather, and Springfield Leather Co.

---

## Bobby Park's Advanced Floral Tooling

### Bob Park

WCC, Ranger 108

Wednesday 8/4 9:00am - 4:00pm

*Advanced*

*Student Limit 12*

\$165.00

While there is a lot of reference material on how to learn the basics of floral tooling, there is very little designed to help take it to the next level. Bobby designed this workshop to do just that! General topics covered are: leather selection, casing the leather, carving solutions, controlling stretch and swivel knife/stamping tool selection. He will talk about a variety of the tooling techniques that he employs on his own projects. He'll be sharing the techniques he's learned over the years to create depth, dimension, texture and highlights. And with the aid of close-up cameras and a large screen TV, each student will have the opportunity to observe these techniques first hand. Instruction will include: the cutting sequence, tooling sequences, beveling without cutting, petal lifting and undercutting, back-beveling and the use of modeling tools. The class will have an opportunity in the afternoon session to apply these techniques on a practice floral tooling pattern. As this is not a project class, there will be no emphasis or pressure to complete the practice patterns. Bobby's focus will be strictly on evaluating each student's skill level and tailoring comments to help them improve. A recommended tool list will be provided to those who sign up for the workshop.

**Materials to Bring:** Stamping tools (a full tool list will be emailed to each student upon registration), stamping surface, swivel knife, strop, maul/mallet of choice, tracing stylus, small sponge or water spray bottle, notepad, pencil and camera.

**Materials for this workshop donated/provided by:**

Hermann Oak Leather Co.

---

## **Bobby Park's Antiquing, Dyeing & Finishing Demonstration**

### **Bob Park**

WCC, Ranger 108

Tuesday 8/3 7:00pm - 10:00pm

*All skill levels welcome!*

*Student Limit 25*

\$85.00

There are so many products available to the leather worker that it is difficult to know what to use or when to use it. Bobby designed this 3-hour demonstration to address the use of a variety of those products. General topics covered will include the use of spirit and water based dyes, acrylic colors, liquid highlighters and paste antiques. Through the use of close-up cameras and a large screen TV, he will share the techniques and sequences that he uses to produce professional-looking finishes. Discussion will include: oiling, brush selection, dyeing tooled backgrounds, dyeing edges, applying acrylic colors, applying paste antique, finish coats and sealants. Throughout the demonstration he will address a variety of products from various manufacturers, alternative applications and the successful methods that he's learned to use over the years. This demonstration covers a lot of ground and is one of Bobby's most popular workshops!

**Materials to Bring:** Note taking materials. Cameras are welcome.

**Materials for this workshop donated/provided by:**

Hermann Oak Leather Co., The Fiebing Co. and Bob Park Custom Leather

---

## **Bobby Park's Burnishing Edges Demonstration**

### **Bob Park**

WCC, Ranger 108

Thursday 8/5 9:00am - 12:00pm

*All skill levels welcome!*

*Student Limit 25*

\$85.00

This is one of the most highly attended demonstrations that Bobby produces. If you are interested in learning various methods to produce professional quality edge finishes, then this is your class! He utilizes close up cameras and a large screen HD TV to demonstrate each step of a number of burnishing techniques. His demonstration of the most popular burnishing machines like Cobra, Weaver and Fantastic Burnisher provides an excellent opportunity to observe their practical applications. Instruction will cover subjects like: types of edgers, sharpening, techniques in hand burnishing, the use of various burnishing solutions, edge dyeing, burnishing with a Dremel and dealing with exotic and chrome tanned leather. Time permitting, there will be an open Q & A session at the end of the demonstration where Bobby will answer questions regarding any subject which may interest the class.

**Materials to Bring:** Note taking materials. Cameras are welcome.

**Materials for this workshop donated/provided by:**

Hermann Oak Leather Co., Leather Machine Co., LLC, The Fiebing Co., and Bob Park Custom Leather

---

## **Bobby Park's Creating Western Floral Designs**

### **Bob Park**

WCC, Ranger 108

Tuesday 8/3 9:00am - 4:00pm

*Intermediate and Advanced*

*Student Limit 12*

\$165.00

If you were standing in the wrong line when they passed out drawing skills, this class is for you! This workshop is designed as an introduction to drawing floral tooling patterns utilizing the techniques outlined in Bobby's book, *Creating Western Floral Designs*. The instruction is designed to assist those who struggle when composing floral tooling patterns. Utilizing close-up cameras and a large screen TV, Bobby outlines the step by step process that he uses when designing patterns. This is not an art class! Rather, it's a mechanical approach to composition utilizing common traditional design elements found in most tooling patterns. The focus is to assist students in designing patterns by following the techniques outlined in the book. Some of the topics covered include basic layout, the use of borders and understanding pattern flow. During the afternoon session the students will practice some basic techniques in drawing, under Bobby's supervision. Loaner copies of *Creating Western Floral Designs* will be available and signed copies will be available for purchase as well.

**Materials to Bring:** Pencils, erasers, circle template (up to 3"), note taking materials and a camera.

**Materials for this workshop donated/provided by:**  
Bob Park Custom Leather

---

## **Bobby Park's Inlays & Filligree**

### **Bob Park**

WCC, Ranger 108

Thursday 8/5 1:00pm - 4:00pm

*All skill levels welcome!*

*Student Limit 25*

\$85.00

In this demonstration, Bobby will share the techniques he uses to filigree tooled backgrounds on projects such as purses, organizers, briefcases, belts, headstalls and other similar projects. With the use of close-up cameras and a large screen TV, he will filigree the background area of a tooling pattern and apply a colored background material. He will also demonstrate the method he uses to create an exotic inlay on the same type of projects. Discussion will include the type and weight of the leathers used, coloring, finishing, cutting tools and gluing. Time permitting, there will be an open Q & A session where Bobby will answer questions regarding any subject which may interest the class.

**Materials to Bring:** Note taking materials, camera.

**Materials for this workshop donated/provided by:**  
Hermann Oak Leather Co. and Bob Park Custom Leather

---

## **Bobby Park's Sharpening Your Bench Tools**

### **Bob Park**

WCC, Ranger 108

Wednesday 8/4 7:00pm - 10:00pm

*All skill levels welcome!*

*Student Limit 25*

**\$85.00**

Having trouble keeping your edger sharp? Does your skiving knife just skip over the top of the leather? If so, then this is the class you need! With the use of close-up cameras and a big screen TV, Bobby will demonstrate how to make your tools cut again! What's more, you'll learn how to keep them sharp. Topics covered in this demonstration include edgers, French edgers, skivers, gouges, stitch groovers, hole punches, tube punches, awls, draw gauge blades, straight blades, round knives and swivel knives. The discussion will include strops, stropping techniques, types of strops, systems and how and when to use them. Bobby will also review the equipment and systems that he uses to maintain the tools on his own bench. Time permitting, there will be an open Q & A session where he will answer questions regarding any subject which may interest the class.

**Materials to Bring:** Note taking materials. Cameras are welcome.

**Materials for this workshop donated/provided by:**

Bob Park Custom Leather

---

## **Chap & Chink Making: An Overview**

### **Bob Klenda**

WCC, Ranger 106

Friday 8/6 7:00pm - 9:30pm

*All skill levels welcome!*

*Student Limit 20*

**\$85.00**

The goal for this class is to provide the student with the knowledge and confidence to make chaps for personal use or as a business. Subject matter offered: The art of taking orders, taking proper measurements, understanding what the measurements mean, selecting suitable leather, doing layout, cutting and construction. Further subject matter: Understanding pattern design, adjustment, and fit as well as the difference between chaps, chinks, and Armitas and what is unique about each. The class will be informal, questions are welcome, and chaps, chinks, etc. will be on display for your inspection.

**Materials to Bring:** Notepad, pencil and camera. Optional: Chaps/Chinks/Armitas you have made.



© jamenmarkmodels

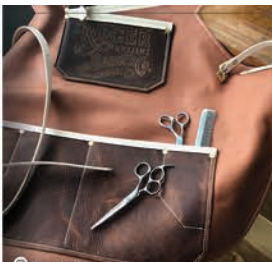

© theadroitco



© leathercraftabero



© royanababam



© onstairchusecorporation



© taylorcombs



© jaylenn



© sophistiquedecor



© jacquelineofathenspa



© jgobvandleather

EST. 1919  
**tandy**  
LEATHER

Show us how you #leathertogogether

LEATHER | HARDWARE | HAND TOOLS | MACHINES | FINISHES & DYES | THREAD & LACE | KITS

**HEART of TEXAS**  
**RECEPTION**  
**SPONSOR**

---

## Chinks 101

### Julie Baugher

WCC, Ranger 107

Tuesday 8/3 1:00pm - 5:00pm

*All skill levels welcome!*

*Student Limit 15*

\$175.00

Taking an order for a pair of Chinks! Learn how to take an efficient, fast order for a pair of Chinks. Time is money, taking an order should be fast and efficient. I will teach you what questions to ask and how to take an order. Also, we will go over where to measure and how to apply those measurements for the best fit. We will talk about variables that you will encounter and what decisions to make based on those variables. If you have some chinks that you have built and want to analyze them, we can do that too! Come with questions you would like to have answered. Note: Workshop registration fee includes your choice of 2 patterns packs – a \$75 value!

**Materials to Bring:** Notebook, pen or pencil, chinks that you would like to look at and analyze.

**Materials for this workshop donated/provided by:**

AA Horse Tack Co.

---

## Chinks 102

### Julie Baugher

WCC, Ranger 107

Wednesday 8/4 1:00pm - 5:00pm

*All skill levels welcome!*

*Student Limit 15*

\$175.00

Chinks 102 will go over the layout and construction methods that apply to building a pair of chinks whether it be round or square leg. We will go over the hardware and materials and tools that can be used in construction. Information pertaining to different fringe applications, yokes trims, back belts, side pieces (side plates) and go over buckstitching, spot setting, pockets and various other things that can be applied to leggings. Again, I encourage you to bring any chinks you have to go over in class so we can analyze them! Note: Workshop registration fee includes your choice of 2 pattern packs – a \$75 value!

**Materials to Bring:** Notebook, pen/pencil for notes.

**Materials for this workshop donated/provided by:**

AA Horse Tack Co.

---

## Common & Creative Closures

### Chuck Dorsett

WCC, Ranger 106

Friday 8/6 1:00pm - 5:00pm

*All skill levels welcome!*

*Student Limit 10*

\$85.00

The closure we choose can be every bit as much a part of the overall design as any other aspect, so, let's get creative! We'll go over the basics like Segma snaps and Sam Brownes, but then build on those and get creative! Turn clasps, leather toggles, and even a good, self-tightening knot for a necklace or a wristband. We'll actually work on 10 closures, but we'll discuss another 8 or 10 that have some real creative possibilities!

**Materials to Bring:** Note taking materials. Weaver Leather will provide all of the supplies.

**Materials for this workshop donated/provided by:**

**22** Weaver Leather



**WEAVER**<sup>TM</sup>  
LEATHER SUPPLY

## INSPIRATION AWAITS

**EVERYTHING YOU NEED TO BUILD THE PERFECT BELT**

Express yourself with our extensive selection of belt making supplies. Whether you're going for a refined or rustic vibe, traditional or trendy, we have what you need to transform your vision into reality. You'll find creative combinations that take your belts to the next level with belt blanks in the finest leathers, hardware in fashionable finishes, and conchos in exclusive designs.

Wholesale: [shop.weaverleather.com](http://shop.weaverleather.com) Retail: [weaverleathersupply.com](http://weaverleathersupply.com) 800-932-8371

**20** Leather Carving Contest **21**  
Title Sponsor

---

## Cowboy Cuffs

### Bob Klenda

WCC, Ranger 106

Thursday 8/5 8:00am - 5:00pm

*All skill levels welcome!*

*Student Limit 6*

\$175.00

Cowboy cuffs have completed a cowboy's outfit for a long time. Bob is offering you an opportunity to make your very own pair. Layout patterns will be supplied, along with flower carving patterns. You can choose to flower carve, basket, block, or border stamp yours. (The carving pattern as shown in the pictured cuffs will be available as well as a simpler pattern. If flower carving even the simpler pattern, expect to complete just one cuff at best during the class.) Students will learn about choosing leather, proper layout, cutting, how to line the inside and do the scalloped fold over, edging, burnishing, punching holes, applying finishes, setting snaps, and lacing or braiding. If flower carving, learn the elements that make a pattern inspirational as well as improving your technique.

**Materials to Bring:** Note taking material, camera, swivel knife, strop, mallet, stamping tools, stamping surface, round knife or favorite cutting knife, slicking wood or glass, wood or poly cutting board, size 4, 5, 6 hole punches, #3 or #4 edger, stitching awl. (Hole punches, lacing, snaps and snap setters will be furnished. If flying to the show, contact Bob at 970-379-7375 to arrange for tools.)

**Materials for this workshop donated/provided by:**

Hermann Oak Leather Co., Klenda Saddlery, and The Fiebing Co.

---

## DIY Marketing: Sell More Stuff

### Michael Magnus

WCC, Ranger 110

Friday 8/6 7:00pm - 10:00pm

*All skill levels welcome!*

*Student Limit 25*

\$85.00

Marketing your business can be frustrating, but it's hard to grow your sales without it. Learn how to build your brand, promote your business, and the do's & don'ts of advertising with Michael Magnus.

**Materials to Bring:** Notebook, pencil/pen, curiosity, and lots of questions!



---

## Fine Assembly Work

### Takeshi Yonezawa

WCC, Ranger 110

Friday 8/6 8:00am - 5:00pm

*All skill levels welcome!*

*Student Limit 10*

\$185.00

This course is designed for the student who wishes to develop their skills and master the fundamentals of assembly work over this full-day class. Instructor Takeshi Yonezawa will share his specialized techniques that took years to develop, focusing specifically on: 1) Skiving leather; 2) Applying bond; 3) Edge work. The valuable skills taught during Fine Assembly Work are foundational to all leather projects, but often get overlooked. However, once in practice, students will enhance their leatherwork and amplify their ability to create fine leather goods. Best of all, these fundamental yet critical skills can be utilized throughout one's entire journey with leather.

**Materials to Bring:** Glue spreader (available for purchase at class), cutter knife (recommended: NT Cutter OLFA), cutting surface, glass surface, (2) rulers (recommended: thin, steel rulers with little flexibility), edger, sandpaper or sanding stick (#400), ballpoint pen or leather marking pen, canvas piece or cotton cloth (to be used for edge burnishing), leathercraft hammer, roller tool, flat edge knife (optional – available for purchase in the workshop).

**Materials for this workshop donated/provided by:**

Hermann Oak Leather Co., The Fiebing Co., Leather Machine Co., LLC, and Renia USA.

---

## Fitting & Choosing a Last

### Lisa Sorrell

WCC, Ranger 106

Friday 8/6 8:00am - 12:00pm

*All skill levels welcome!*

*Student Limit 8*

\$120.00

Demonstration of how I measure the foot (each student can have their foot measured and take home the results) followed by talking about how to choose a last and fit the last to the wearer's measurements. I will have fitted lasts for use as demonstration and there will be plenty of time for discussions and questions. Please feel free to bring your own last for discussion.

**Materials to Bring:** Your own last, or a last you have questions about how to customize.

**Materials for this workshop donated/provided by:**

Sorrell Notions & Findings

# LEATHER MACHINE COMPANY

WE DEFINE  
**CUSTOMER**  
SERVICE!

COBRA Class 3



COBRA Class 4-P



COBRA Class 14



COBRA Class 17



COBRA Class 20



**New!** COBRA AK 20 PLUS **New!**

### INTRODUCING

The Cobra AK 20 Plus...  
a 20" full capacity  
leather strap cutting  
machine for all types of  
straps, belts, fringe, etc...



COBRA Class 26



COBRA 5550



COBRA 8810



COBRA Burnisher



COBRA NP 10



STITCH



SPLIT



SKIVE



STRAPS



CLICK/CUT



BURNISH



FINISH

HEART of TEXAS  
RECEPTION

SPONSOR

ASK US HOW YOU CAN  
**BECOME A MEMBER**  
OF THE COBRA FAMILY

**COBRA Class 18**



**COBRA 5110**



**COBRA 10 Ton Clicker**



**HIGHEST  
QUALITY  
MACHINERY  
FOR LEATHER**

[leathermachineco.com](http://leathermachineco.com)

**866-962-9880**

Leather Machine Co, Inc. Warehouse 2141 E. Philadelphia St. "U" Ontario, CA. 91761 • Email: [cobra@leathermachineco.com](mailto:cobra@leathermachineco.com)

**HEART of TEXAS  
RECEPTION**

**SPONSOR**

---

## Floral Pattern Layout

### Al Gould

WCC, Ranger 109

Saturday 8/7 8:00am - 12:00pm

*All skill levels welcome!*

*Student Limit 15*

\$85.00

Discover floral pattern layout, combined with geometric and basket stamping. Learn how to draw patterns properly within a given space while maintaining symmetry, balance and flow. Further instruction involving basic pattern components (flowers, buds, leaves, stems and fillers) will open up inexhaustible possibilities for pattern layout. Then, add borders to complete your designs using cut lines, beaded and serpentine accents. A tried and true course that is a favorite with students, year after year.

**Materials to Bring:** Plain drawing paper, pencils and an eraser.

---

## Leather FUNDamentals

### Serina Lee

WCC, Lone Star 105

Thursday 8/5 9:00am - 5:00pm

*Beginner*

*Student Limit 15*

\$165.00

This workshop will be action-packed and Fun!! The focus of this workshop will be to learn the basics! Types and weights of leather and its uses will be covered, to learn which leather is best for which project. You will also learn how to case veg tan leather to prepare it for tooling, prepare the leather for the least amount of stretch and we will also be tooling a small piece. This workshop will be very hands on with lots of interaction. My goal is to help you learn the basics but also give you lots of tips and tricks to making a beautiful, finished product!! Come on! Let's play with leather!!

**Materials to Bring:** Maul/mallet, basic 7 stamping tools (beveler, veiner, camouflage, seeder, backgrounder, pear shader, and mules foot), sharp swivel knife, strop, fine point stylus, straight edge/ruler, stamping stone, notebook and pen.

**Materials for this workshop donated/provided by:**

Hermann Oak Leather Co. and The Fiebing Company

---

## Leather Tree Diorama

### Tony Bernier

WCC, Ranger 108

Friday-Saturday 8/6-8/7 9:00am - 5:00pm

*All skill levels welcome!*

*Student Limit 25*

\$250.00

Make a beautiful, picturesque diorama using leather dust, wool, boar's hair, and wire to create natural-looking scenery. Learn the skills needed to form the various shapes and add color that will make anyone look twice to be sure the plant life isn't real! Surprisingly easy, you'll have fun shaping and forming as you fill the space and create a "story" with leather dust and colors.

**Materials to Bring:** Just your imagination, as all the rest will be provided for you.

**Materials for this workshop donated/provided by:**

The Fiebing Co., Renia USA, and Tony Allen Bernier

*Renia*  
Bonding for Life

**NEW Renia-**

# 3D Embossing Filler

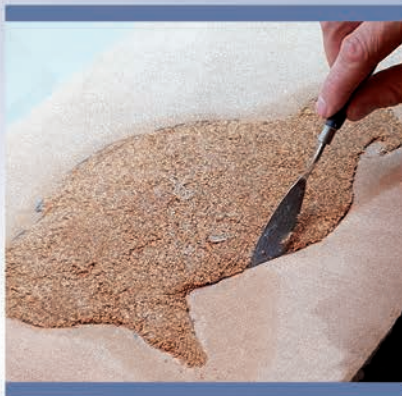

Best for embossing work, quick-drying, great stability, perfect support for further carving. Easy application - does not stick to applicator. Dries within 1-2 hours, can be accelerated with heat. Sizes: 8 oz, 16 oz



## Renia USA Inc.

6180 Atlantic Blvd. · Suite N  
Norcross, GA 30071

www.renia.us · info@renia.us

P: 470-395-6280 · F: 770-234-5952

Toll-free: 844-481-9668

Ask your supplier about this new addition to the Renia line!

Official  
Workshop  
Sponsor

---

## Leatherwork Personal Training

### Bob Klenda

WCC, Ranger 106

Saturday 8/7 Time: see description

*All skill levels welcome!*

*Student Limit 1*

\$100.00

Bring a sampling of your work for a 1-on-1 critique of your leather carving and/or stamping, saddle or chap making. Ask questions, discuss your hopes and struggles. Receive ideas, information on ways of doing things and confidence. Discuss leather, design, tools, and habits. Call the Journal to register: 715-362-5393. 2 time slots available: 1pm - 2pm; 3pm - 4pm; Assigned on a first-come, first-served basis.

**Materials to Bring:** Bring a sampling of your successes and struggles whether it be leather or the tools that you use. Bring pictures or samples of what you're trying to achieve. Bring a list of questions and things that you would like to discuss. All students under 18 must be accompanied by an adult.

---

## Let's Make Saddle Bags!

### Bob Klenda

WCC, Ranger 106

Tuesday-Wednesday 8/3-8/4 8:00am - 5:00pm

*Intermediate*

*Student Limit 6*

\$345.00

In this 2-day workshop, the student will build and take home a medium sized pair with an accordion-style gusset. Bob will explain styles, materials and construction methods as well as the methods of attaching saddle bags to a saddle. Patterns will be supplied, student will lay out, cut, stamp, rivet, sew, edge, oil and polish the pair that they make. Time will only permit a simple border stamp (bring a favorite).

**Materials to Bring:** Notepad, pencil, camera, swivel knife, strop, mallet, stamping tools, stamping surface, round knife or favorite cutting knife, wood or poly cutting surface, heavy scissors, #2 and #3 edgers, edge rubbing supplies, and a broad-faced hammer. Bob will supply tools for those who don't have all the listed tools. If flying to the trade show, contact Bob at 970-379-7375 to arrange for tools.

**Materials for this workshop donated/provided by:**

Hermann Oak Leather Co., The Fiebing Co., Leather Machine Co., LLC, Renia USA, and Klenda Saddlery

---

## Modifying Your Old Stamps

### Clay Miller

WCC, Ranger 107

Wednesday 8/4 7:00pm - 10:00pm

*All skill levels welcome!*

*Student Limit 25*

\$85.00

Have you ever tooled a project that you simply didn't have the right tool for? Perhaps it was just a bit too large? Need a tool that's no longer in production or maybe it's damaged? Learn how to modify your stamping tools using a belt grinder and/or a two-wheel bench grinder. Get them to fit older-style (Stohlman, Porter, etc.) tooling patterns or create something new to better fit your personal style of tooling. Hone dull designs for like-new impressions. Clay will present several tools to alter, addressing: 1) Why alter a specific tool? 2) What do you want the tool to be able to do? 3) What does it stamp like now vs. after alteration? Note: This is a demonstration, but it is still recommended that you are familiar with the use of grinders. Safety concerns and precautions while using this machinery will be addressed.

**30** **Materials to Bring:** Note taking materials.

---

## Precision Stamping with Barry King

### Barry King

WCC, Ranger 107

Thursday 8/5 8:00am - 12:00pm

*All skill levels welcome!*

*Student Limit 16*

\$95.00

Barry King has produced thousands of basket stamps over the years and he's tried every single one of their designs! This workshop will consist of basic to advanced designs using your tools. Barry will begin with design overview of placing brands, initials, or floral designs into the geometric patterns. You'll learn proper usage of tools to create the designs they are meant to create, and then use the same tools to create new designs. Attention will be given to how to orient the tools so that they line up as well as address how to fit your design within an allocated space (border-to-border). There will be open discussion for any questions on finishing projects as well. Barry will have many tools available to try to see what designs you can create with them.

**Materials to Bring:** Stamping stone, mallet/maul, ruler, square, stylus, geometric tools, wing dividers, note taking materials and a camera.

**Materials for this workshop donated/provided by:**

Hermann Oak Leather Co., Barry King Tools

---

## Pricing Your Work

### Bob Brenner

WCC, Ranger 106

Saturday 8/7 8:00am - 12:00pm

*All skill levels welcome!*

*Student Limit 20*

\$95.00

Bob Brenner is the leather industry authority with decades of experience on how to price your work. Are you profitable? Even if you are, this workshop is designed to help you maximize your profits and avoid common pitfalls. This is a packed, 4-hour workshop based on Bob's book, "How to Establish Prices for the Saddle Maker or Leather Worker". Each student will receive his book (a \$39.95 retail value) during the workshop, which will help you greatly in your note taking while Bob is teaching. This proven system will teach you how to establish a profitable hourly rate and price for your services and products, and it is updated by Bob continuously to reflect fair market pricing. Having a Business Administration Degree from Colorado State University and spending 11 years in the banking industry, Bob set up every day, real world accounting systems in his shop which are the basis for the book. These strategies can be used for anything you make. Bob uses this same system in his shop on a daily basis and this is his 21st year teaching this workshop, which tells you it is a valuable resource. If you've made it, he's priced it – profitably!

**Materials to Bring:** Note taking materials.

---

## Repeating (Belt) Design

### Don Gonzales

WCC, Texas South 118

Thursday 8/5 9:00am - 3:00pm

*Intermediate and Advanced*

*Student Limit 12*

\$165.00

This workshop is focused on the application of stamping tools in a floral pattern using one of Don's unique designs. Following along with Don, you'll tool one section of a repeating pattern from start to finish on a practice piece of Hermann Oak leather, providing you with a good idea of what the pattern is and how it should look. You'll then dye the stamped leather using Don's most popular two-tone dye application process and finish it with a light oil antique. Don gets a lot of questions on his antique and finish techniques and this workshop will definitely deliver! Time permitting, Don will answer questions about construction. Each student will receive their own belt blank and liner (in addition to the practice piece) and a handout with further reference notes. This is the perfect complimentary workshop for Sickbald's Belt Basics!

**Materials to Bring:** Swivel knife, strop, mallet/maul, stylus, spray bottle with water, standard floral carving tools (lifters, bevelers, thumbprints/pear shaders, backgrounders/matters, wing dividers, a sheet of tracing paper, stamping stone, and anything else you'd normally use to sit down and tool a belt with.

**Materials for this workshop donated/provided by:**  
Hermann Oak Leather Co. and the Fiebing Company

---

## Roll the Dice!

### Serina Lee

WCC, Lone Star 105

Saturday 8/7 9:00am - 5:00pm

*All skill levels welcome!*

*Student Limit 15*

\$185.00

This class will teach the construction of a heavy weight dice cup. This cup is made without having to sew it. It will be laced up the back but I will show you how to construct it in a way that the bottom is only glued and not sewn on. Students will tool a simple pattern on the front (the Texas flag if you want!), but will mainly focus on the construction so that you will go home and be able to make more! Game night will never be the same!! Roll the dice!! But NO cheating!!!

**Materials to Bring:** Basic bevelers, modeling tool, mallet/maul, metal square, sharp knife, wing dividers, 1/8-inch lacing chisel, lacing fid, cutting board, tooling stone, skiving tool, large edger (we will be edging 14-16 oz. leather), small detail brush for dye, whatever you use to burnish your edges (products and tools) and a strap cutter.

**Materials for this workshop donated/provided by:**  
Hermann Oak Leather Co., The Fiebing Co., and Leather Machine Co., LLC



Heart of Texas  
Reception  
Sponsor



Official  
Workshop  
Sponsor



Prep

Edge Finishes



Dyes



Antiques

Top Finishes

[www.fiebing.com](http://www.fiebing.com)

---

## Saddle Solutions: All 4 Saddle Workshops

### Al Gould

WCC, Ranger 109

Thursday-Friday 8/5-8/6 8:00am - 5:00pm

*All skill levels welcome!*

*Student Limit 20*

\$400.00

Sign up for all 4 of Al Gould's saddle workshops (Parts 1 - 4) and receive a huge discount! Save \$100 by choosing this option.

**Materials to Bring:** Notebook, pencils and eraser.

**Materials for this workshop donated/provided by:**

Hermann Oak Leather Co. and Renia USA

---

## Saddles – Part 1: Ground Seat

### Al Gould

WCC, Ranger 109

Thursday 8/5 8:00am - 12:00pm

*All skill levels welcome!*

*Student Limit 20*

\$125.00

Part 1 in a 4-part series! Al will build an entire ground seat in this workshop, while discussing the shaping of it as well. (Special Offer: Select all 4 parts in the series – Saddle Ground Seat, Saddle Fit-Up, Saddle Front and Saddle Cantle Binding – and save \$100! Register for Saddle Solutions; see Registration Form).

**Materials to Bring:** Notebook, pencils and eraser.

**Materials for this workshop donated/provided by:**

Hermann Oak Leather Co. and the Fiebing Company

---

## Saddles – Part 2: Saddle Fit Up

### Al Gould

WCC, Ranger 109

Thursday 8/5 1:00pm - 5:00pm

*All skill levels welcome!*

*Student Limit 20*

\$125.00

Part 2 in a 4-part series! This course will demonstrate how to fit, mark and cut the saddle skirts, rigging and the seat to fit the rider and the purpose of the saddle. Al will instruct on how to find the elusive shape, balance and function with saddle fit-up, and will demonstrate a variety of rigging styles and applications. (Special Offer: Select all 4 parts in the series – Saddle Ground Seat, Saddle Fit-Up, Saddle Front and Saddle Cantle Binding – and save \$100! Register for Saddle Solutions; see Registration Form).

**Materials to Bring:** Notebook, pencils and eraser.

**Materials for this workshop donated/provided by:**

Hermann Oak Leather Co. and Renia USA

---

## Saddles – Part 3: Front

### Al Gould

WCC, Ranger 109

Friday 8/6 8:00am - 12:00pm

*All skill levels welcome!*

*Student Limit 20*

\$125.00

Part 3 in a 4-part series! Al will show you his favorite ways to cover the horn, considerations for covering the fork, and he will address the many factors that come into play when deciding on gullet height. (Special Offer: Select all 4 parts in the series – Saddle Ground Seat, Saddle Fit-Up, Saddle Front and Saddle Cattle Binding – and save \$100! Register for Saddle Solutions; see Registration Form).

**Materials to Bring:** Notebook, pencils and eraser.

**Materials for this workshop donated/provided by:**

Hermann Oak Leather Co. and Renia USA

---

## Saddles – Part 4: Cattle Binding

### Al Gould

WCC, Ranger 109

Friday 8/6 1:00pm - 5:00pm

*All skill levels welcome!*

*Student Limit 20*

\$125.00

Part 4 in a 4-part series! Cattle binding application is one of the most troubling tasks of saddle making. In this workshop, learn to shape a Cheyenne roll to your advantage; prepare leather for ease of application; apply the binding, secure it in place and shape it for sewing. (Special Offer: Select all 4 parts in the series – Saddle Ground Seat, Saddle Fit-Up, Saddle Front and Saddle Cattle Binding – and save \$100! Register for Saddle Solutions; see Registration Form).

**Materials to Bring:** Notebook, pencils and eraser.

**Materials for this workshop donated/provided by:**

Hermann Oak Leather Co. and Renia USA

---

## Sculpted 3-D Magnolia

### Annie Libertini

WCC, Ranger 107

Friday 8/6 9:00am - 5:00pm

*All skill levels welcome!*

*Student Limit 15*

\$165.00

In this one-day workshop you will learn leather sculpting techniques and create a life-like, three-dimensional magnolia using only your hands and a few basic tools. Each student will be instructed in manipulating the leather to make natural looking flowers and leaves and in using water-based dyes and acrylic paint to bring them to life! At the end of the class the flowers will be assembled and can be made into pins or ornaments.

**Materials to Bring:** Paper and pencil, stylus, modeling spoon, awl, safety skiver or skiving blade, misting spray bottle for water, paintbrushes if you have ones you prefer. Annie will have extra tools available.

**Materials for this workshop donated/provided by:**

Hermann Oak Leather Co. and Renia USA

# REALEATHER®

A full leather craft and supply product line including craft laces, leather straps, leathercraft kits, paints, hardware, tools, and more!



Available at craft stores and leather craft distributors nationwide.

Contact us today at:

Silver Creek Leather Co.

812.945.8520 | [realeather.com](http://realeather.com) | [info@silvercreekleather.com](mailto:info@silvercreekleather.com)

**VETERANS &  
YOUTH WORKSHOPS  
SPONSOR**

---

## Shotgun Chaps Pattern Drafting

Julie Baugher

WCC, Ranger 107

Thursday 8/5 1:00pm - 5:00pm

*All skill levels welcome!*

*Student Limit 15*

\$175.00

This class will teach you how to draft a pattern for Shotgun Chaps for an individual person. This method, once understood is so simple, easy and fast it will only take you 5-10 minutes per pattern once you get the hang of it! I will go over all the variables that go along with it. We will go over how to take an order for shotguns, where and how to measure correctly, how to apply those measurements and where to adjust accordingly. This base will give you the opportunity to build on your chapmaking skills and be more efficient. Note: Workshop registration fee includes your choice of 2 pattern packs – a \$75 value!

**Materials to Bring:** Cloth tape, tape measure, 6" x 24" quilter's grid, pencils, eraser, and notebook.

**Materials for this workshop donated/provided by:**

Julie Baugher Leather Design and Renia USA

---

## Silver Creek Leather's Introduction to Leathercraft for Youths

Greg Sartor

WCC, Ranger 110

Saturday 8/7 9:00am - 12:00pm

*Beginner*

*Student Limit 12*

Free

Silver Creek Leather Co. presents an introduction workshop for youth of all skill levels, ages 8-15. Each student will receive a Realeather Discover Leathercraft Kit to use in the classroom and take home! All kits include multiple leathercraft projects, stamping tools, dyes, supplies, patterns and instructions needed to finish the projects. In the class, instructors will demonstrate and help with the basics of stamping, tooling, dyeing and working with leather. Class attendance will include free admission to the trade show.

**Materials to Bring:** All materials will be provided by Silver Creek Leather Co.

**Materials for this workshop donated/provided by:**

Silver Creek Leather Co.

---

## Silver Creek Leather's Workshop for Veterans

Greg Sartor

WCC, Lone Star 105

Sunday 8/8 9:00am -12:00pm

*All skill levels welcome!*

*Student Limit 12*

Free

This workshop is specifically designed for U.S. Military Veterans who are interested in leathercraft. Greg Sartor, owner of Silver Creek Leather Company, will teach about leatherwork as you create a custom valet tray. The focus of the project will be to learn and practice the basics of stamping and tooling. Later, Greg will take you on a tour through the trade show to introduce you to the vendors and talk about the supplies at hand.

**Materials to Bring:** All materials will be provided by Silver Creek Leather Co.

**Materials for this workshop donated/provided by:**

Silver Creek Leather Co.

---

## **Slickbald & Beard's Framed Picture (Combo)**

### **Chris/Robert Andre/Beard**

WCC, Lone Star 104/Ranger 110

Wednesday-Thursday 8/4-8/5 8:00am - 5:00pm

*All skill levels welcome!*

*Student Limit 15*

**\$300.00**

This is a combo workshop with Slickbald and Robert Beard over two days. On Day 1, you'll cut and carve a floral pattern into a picture frame with Slickbald, creating lively contours through the use of bevelers, backgrounders, lifters, etc., and understanding how to carve with perspective for a "natural" look. You'll then cut out the frame to prepare it for Day 2. On Day 2, Robert will lead you through the creation of one of his popular, 3D desert scenes, which use real turquoise stone and colors. Towards the end of Day 2, you'll insert the finished 3D "diorama" into the frame you completed in Day 1 and put a finish on the whole project. (Note: Day 1 and Day 2 may be taken as stand-alone workshops.)

**Materials to Bring:** Maul/mallet, swivel knife and blades, filligree chisels and/or #11 X-Acto knife, French edger, figure bevellers, common beveller, small pear shaders, veiner, leaf liner, small under beveller, horizontal thumbprint, strop, cutting board, #4 pointed paintbrush, artist's palette and stamping stone. Floral stamping tools: bevelers, veiners, pear shaders, cams, mule foot, lifter or undercutter, backgrounders and stops. Robert will have Pro Series Tools for students to try/purchase.

**Materials for this workshop donated/provided by:**

Hermann Oak Leather Co.

---

## **Slickbald & Beard's Framed Picture (Day 1 only)**

### **Chris Andre**

WCC, Lone Star 104

Wednesday 8/4 8:00am - 5:00pm

*All skill levels welcome!*

*Student Limit 15*

**\$165.00**

This workshop is intended to be Day 1 of a two-day workshop with Slickbald and Robert Beard. In this workshop, you'll cut and carve a floral pattern into a picture frame with Slickbald, creating lively contours through the use of bevelers, backgrounders, lifters, etc., and understanding how to carve with perspective for a "natural" look. You'll then cut out the frame to prepare it for Day 2. (Note: Day 1 may be taken as a stand-alone workshop; to sign up for both days, please select Slickbald & Beard's Framed Picture - Combo and save \$30!)

**Materials to Bring:** Maul/mallet, swivel knife and blades, filligree chisels and/or #11 X-Acto knife, French edger, figure bevellers, common beveller, small pear shaders, veiner, leaf liner, small under beveller, horizontal thumbprint, strop, cutting board, and a stamping stone.

**Materials for this workshop donated/provided by:**

Hermann Oak Leather Co.

---

## Slickbald & Beard's Framed Picture (Day 2 only)

### Robert Beard

WCC, Ranger 110

Thursday 8/5 9:00am - 5:00pm

*All skill levels welcome!*

*Student Limit 15*

\$165.00

This workshop is intended to be Day 2 of a two-day workshop with Slickbald and Robert Beard. In this workshop, Robert will lead you through the creation of one of his popular, 3D desert scenes, which use real turquoise stone and colors. Towards the end of the workshop, you'll insert the finished 3D "diorama" into the frame you completed in Day 1 and put a finish on the whole project. (Note: Day 2 may be taken as a stand-alone workshop; to sign up for both days, please select Slickbald & Beard's Framed Picture – Combo and save \$30!)

**Materials to Bring:** Swivel knife and blades, strop, maul/mallet, #4 pointed paintbrush, artist's palette and stamping stone. Floral stamping tools: bevelers, veiners, pear shaders, cams, mule foot, lifter or undercutter, backgrounders and stops. (See page 4 for traveling board/stone combo). Robert will have Pro Series Tools for students to try/purchase.

**Materials for this workshop donated/provided by:**

Hermann Oak Leather Co.

---

## Slickbald's Advanced Carving Techniques

### Chris Andre

WCC, Lone Star 104

Thursday 8/5 8:00am - 5:00pm

*All skill levels welcome!*

*Student Limit 12*

\$165.00

Together with Slickbald, you will make a 3-D, filigreed floral carving with inlaid stones, suitable for framing. While we will focus on 3-D floral tooling techniques, we will also learn to filigree and set stones. Not enough? How about learning how to lay out a perfect meander border? More? Resist and antique will also be covered. You cannot get more from a one day workshop!

**Materials to Bring:** Basic carving tools: swivel knife, strop, common beveller, figure bevellers, thin veiner, small smooth pear shaders, modeling spoon, horizontal thumbprint, small lifter, 12mm meander stamp, dividers, ruler, filigree chisels, French edger, maul/mallet, water sprayer/mister, and a stamping stone. (He will have a limited number of tools to share).

**Materials for this workshop donated/provided by:**

Hermann Oak Leather Co.

---

## Slickbald's Belt Basics

**Chris Andre**

WCC, Lone Star 104

Wednesday 8/4 7:00pm - 10:00pm

*All skill levels welcome!*

*Student Limit 10*

\$85.00

Learn the fundamentals of belt construction with Slickbald. Slickbald will construct a pant belt from start to finish in this workshop. He will cover sizing (length and width), belt and liner weights, splitting the liner, filligree, adhesives, design centering and layout, curving a belt to fit hips, hardware installation and choice, edge finishing, stitching, and applying a finish to the belt. This workshop will also cover shop tips and production techniques to help the student hit the ground running. This is the perfect complimentary workshop for Don Gonzales' Repeating Belt Design!

**Materials to Bring:** Notetaking materials.

**Materials for this workshop donated/provided by:**

Hermann Oak Leather Co., The Fiebing Co., Leather Machine Co., LLC, and Renia USA.

---

## Slickbald's Concealed Carry Gunleather

**Chris Andre**

WCC, Lone Star 104

Friday 8/6 8:00am - 5:00pm

*All skill levels welcome!*

*Student Limit 10*

\$200.00

Learn the fundamentals of professional holster design and construction. This workshop will focus on concealed carry holsters with the student making a One Slot, "Nelson No 1" style holster. Chris will cover the fitting of the holster style to the customer, types of holsters and their applications, as well as designing holsters from scratch. In construction we will cover leather selection, liners, wet molding and more. The class will also cover shop tips and production techniques to help the student hit the ground running. Students will receive one of Slickbald's 1 Slot Holster Master pattern packs.

**Materials to Bring:** Students should have their own professional collection of properly shaped, sharpened, and polished tools: pencil, head knife or similar, strop, 3/8" round punch, one medium sized (#3/4) French skiver, #3 and #5 common edge bevelers, slicker, and wing dividers. Chris will try to bring tools to fill in the gaps.

**Materials for this workshop donated/provided by:**

Hermann Oak Leather Co., The Fiebing Co., and Leather Machine Co., LLC



---

## Slickbald's Cowboy Action Gunleather

**Chris Andre**

WCC, Lone Star 104

Saturday 8/7 8:00am - 5:00pm

*All skill levels welcome!*

*Student Limit 8*

\$200.00

Learn the fundamentals of professional Western gunleather design and construction. This workshop will focus on Western holsters for Cowboy Action Shooting with the student making one "fast draw" style holster. Chris will cover the fitting of the holster style to the customer, types of holsters and their applications, as well as designing holsters from scratch. In construction we will cover leather selection, the welt seam, liners, wet molding and more. The workshop will also cover shop tips and production techniques to help the student hit the ground running. Students will receive one of Slickbald's Cowboy Holster Master Pattern pattern packs.

**Materials to Bring:** Students should have their own professional collection of properly shaped, sharpened, and polished tools: pencil, head knife or similar, strop, round punches (5-16" & 3/8"), one medium-sized (#3/4) French skiver, #3 and #5 common edge bevelers, #11 Exacto style knife, slicker, wing dividers, needle-nose pliers, and a lace puller if you have one. Chris will try to bring tools to fill in the gaps.

**Materials for this workshop donated/provided by:**

Hermann Oak Leather Co. and Leather Machine Co., LLC

---

## Slickbald's Demystifying the Stitcher

**Chris Andre**

WCC, Lone Star 104

Sunday 8/6 8:00am - 11:00am

*All skill levels welcome!*

*Student Limit 25*

\$85.00

If you have ever been stumped by your sewing machine, are the proud owner of a new stitcher, or are planning on purchasing a stitcher, this workshop is for you. Chris "Slickbald" Andre will address setting up a Class 4 Cobra machine (or similar), finding "home", tension and thread weights, and go over the accessories as well. Many applications will be demonstrated. Questions are encouraged and students will have the opportunity to practice with the stitchers on hand.

**Materials to Bring:** Note taking materials.

**Materials for this workshop donated/provided by:**

Leather Machine Co., LLC

---

## Swivel Knife Finesse

### Al Gould

WCC, Ranger 109

Saturday 8/7 1:00pm - 5:00pm

*All skill levels welcome!*

*Student Limit 15*

\$95.00

Designed to add style to your swivel knife work, this workshop will help you learn to make the swivel knife the integral and indispensable tool for your leatherwork. Al will show you how to “run” with your cuts, how to cut floral designs, borders, leaves and stems, stand alone cuts and basic, decorative cuts. Al is ready to answer all questions related to swivel knife finesse, including all the various types of blades and bevels, so bring your most challenging questions. Sharpening and maintaining the edge on your knives will also be covered. Learn the best blade to use for each specific job. By the end of this workshop, you should feel as though you and your swivel knife (knives?) are well acquainted!

**Materials to Bring:** Swivel knife, strop, notebook and pencil.

**Materials for this workshop donated/provided by:**

Hermann Oak Leather Co.

---

## The “Sarge” (Tuesday)

### Aaron Heizer

WCC, Ranger 109-110

Tuesday 8/3 8:00am - 5:00pm

*All skill levels welcome!*

*Student Limit 10*

\$250.00

Create a stylish, military-style, leather shoulder bag! Students will learn and utilize various construction techniques and sewing skills pertaining to each part of the bag. This useful bag will include an exterior zippered pocket, focusing on proper zipper installation as well as breaking teeth from a zipper to customize it. Measuring approx. 23 x 11 inches when closed, the construction includes making a carry handle as well as a comfort shoulder strap to complete the look. The hardware is custom-made by Aaron – and he will share with you how you can make your own custom, solid brass hardware! (Choose either Tuesday or Wednesday)

**Materials to Bring:** Straight edge, rotary cutter, scissors, mallet/maul, note taking materials, and coffee for Janie Sue.

**Materials for this workshop donated/provided by:**

Maker’s Leather Supply

---

## The “Sarge” (Wednesday)

Aaron Heizer

WCC, Ranger 109-110

Wednesday 8/4 8:00am - 5:00pm

*All skill levels welcome!*

*Student Limit 10*

\$250.00

Create a stylish, military-style, leather shoulder bag! Students will learn and utilize various construction techniques and sewing skills pertaining to each part of the bag. This useful bag will include an exterior zippered pocket, focusing on proper zipper installation as well as breaking teeth from a zipper to customize it. Measuring approx. 23 x 11 inches when closed, the construction includes making a carry handle as well as a comfort shoulder strap to complete the look. The hardware is custom-made by Aaron – and he will share with you how you can make your own custom, solid brass hardware! (Choose either Tuesday or Wednesday)

**Materials to Bring:** Straight edge, rotary cutter, scissors, mallet/maul, note taking materials, and coffee for Janie Sue.

**Materials for this workshop donated/provided by:**  
Maker's Leather Supply

---

## Tooling Realistic Portraits: Sitting Bull

Annie Libertini

WCC, Ranger 107

Saturday 8/7 9:00am - 5:00pm

*Intermediate*

*Student Limit 12*

\$165.00

In this one day workshop you will learn to tool a realistic, lifelike portrait of Sitting Bull. In the process of tooling this portrait, Annie will show you how to make a tracing pattern from a photograph and how to use basic tools to create dimension and capture the details of character and personality that should shine through in every portrait. She will also discuss how to choose the best images to use for portraits and how to translate them to leather so that you will be ready to take these skills home and do your own! Although we will not have time to color the pictures, time permitting Annie will demo how she colors and finishes her portraits.

**Materials to Bring:** (Tandy product codes are given as examples.) Pencil and paper, stamping stone, stylus, swivel knife and strop, maul or mallet, misting spray bottle for water (water and sponges will also be available), small round modeling spoon (#8039-01), med/large round modeling spoon (#8039-02), ball end modeling tool (#8039-04), any other favorite modeling tools, hair blade tool (#88012-00), smooth and checked bevelers, smooth and checked pear shaders (small and large), your preferred background/matting tools.

**Materials for this workshop donated/provided by:**  
Hermann Oak Leather Co.



Airbrushing Dye on Leather

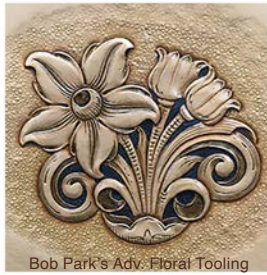

Bob Park's Adv. Floral Tooling



Bob Park's Antiquing, Dyeing, Fin.



Bob Park's Burnishing Edges

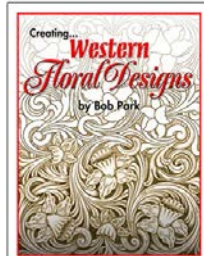

Bob Park's Adv. Creating West. Fl.



Chap & Chink Making



Chinks 101



Chinks 102



Cowboy Cuffs



Fine Assembly Work



Fitting & Choosing a Last



Leather Tree Diorama



Let's Make Saddle Bags!



Precision Stamping with B.K.

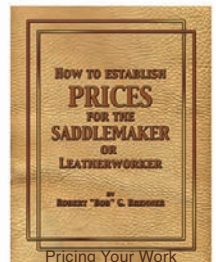

Pricing Your Work



Roll the Dice!



Saddle Workshops



Sculpted 3-D Magnolia



Shotgun Chaps



SCL's Leather Workshop for Veterans



Slickbald & Beard's Framed Picture



Slickbald's Adv. Carving Techniques



Slickbald's Concealed Carry GL



Slickbald's Cowboy Action GL



Swivel Knife Finesse



The "Sarge"



- Cancellation Policy**
- If you cannot attend your workshop(s) due to sudden illness, workshop registration fees will be refunded in full if canceled by July 31, 2021. After July 31, a credit will be applied to your account.
  - Should workshops be cancelled by *Leather Crafters & Saddlers Journal*, all registrants in those workshops will receive automatically a full refund of the registration fee(s).

*It is our goal to provide a safe, fun, and relaxed learning environment at our shows, while following protocols for the proper and acceptable sharing and use of information gleaned while attending.*

*All trade show participants will be expected to read and observe the show policies delineated on page 14 of this booklet.*

TRADE SHOW & WORKSHOPS HOSTED BY:

# LEATHER CRAFTERS & SADDLERS JOURNAL

For information, call: 888•289•6409  
www.LeanerCraftersJournal.com

---



Friday, Aug. 6<sup>th</sup> 9 a.m. - 6 p.m.

Saturday, Aug. 7<sup>th</sup> 9 a.m. - 5 p.m.

Sunday, Aug. 8<sup>th</sup> 9 a.m. - 2 p.m.

**HEART of TEXAS**  
LEATHER SHOW

**FREE ADMISSION TO  
THE SHOW**



**WACO CONVENTION CENTER**

100 WASHINGTON AVE  
WACO TX 76701

**BRAZOS BALLROOM**

---

HOST HOTEL:

**Hilton**

**HILTON WACO**

(next to the convention center)

113 S University Parks Dr, Waco, TX 76701

\$149/night + tax

Group Code: HOT

(254) 754-8484

SKIRTING • HARNESS • LATIGO • HOLSTER • RAWHIDE • TOOLING

## Hermann Oak Russet Skirting Leather Carves Like Butter and Stamps to an Incredible Depth

The unique color, the way it oils so evenly, the clean flesh, firmness and its excellent yield give your work a uniqueness like no other. Our leather is crafted to last a lifetime. Your work of art will keep its body and beauty long after others sag and fade.

Hermann Oak Leather is the last of the Vegetable Tanners using traditional tanning methods. Made in the USA with US steer hides.

Since 1881



**Bowden Leather Company**  
El Paso, TX • 915-877-1557  
**Goliger Leather Company**  
Ventura, CA • 800-423-2329  
**Hide & Leather House, Inc.**  
Napa, CA • 707-255-6160  
**Montana Leather Company**  
Billings, MT • 406-245-1660  
**Oregon Leather Company**  
Portland, OR • 503-228-4105  
**Panhandle Leather Company**  
Amarillo, TX • 806-373-0535  
**Springfield Leather Co.**  
Springfield, MO • 800-668-8518  
**Weaver Leather**  
Mt. Hope, OH • 800-WEAVER-1  
**Buckskin Leather Company**  
Calgary, Alberta, Canada • 888-723-0806  
**Craft & Company Ltd.**  
Suginami-ku, Tokyo, Japan • 011-81-3-3393-2222  
**Kyoshin Elle & Co., Ltd.**  
Taito-Ku, Tokyo, Japan • 011-81-3-3866-3221  
**Star Trading Co.**  
Maniwa, Japan • 011-81-8-6742-8004  
**Soft Art**  
Murrhardt, Germany • 011-49-7192-212-370  
**Toowoomba Saddlery**  
Toowoomba, QLD, Australia • 011-617-4633-1855

Saddle By Keith Seidel

Hermann Oak Leather Co.  
St Louis, Missouri USA  
[hermannoakleather.com](http://hermannoakleather.com)



**HEART of TEXAS**  
**RECEPTION**

**SPONSOR**

## INSTRUCTORS



### Chris Andre

"Slickbald" is a professional leather artist and maker in Colorado. Chris works mostly in cowboy action and concealed carry gun leather while dabbling in saddles, cowboy trappings and motorcycle gear. Chris is also an active and competitive member of SASS and Cowboy Fast Draw, and is a lifetime competitive shooter. Chris authors a variety of instruction and pattern packs for gun leather and other items as well as offering workshops in holster making and carving.

---



### Julie Baugher

has been building custom leather goods for 39 years. She attended Spokane Falls Community College, learning to build saddles under Jesse Smith. Her career started in Laramie, Wyoming at The Boardwalk. Next, she co-owned Ellensburg Saddle Company in Ellensburg, Washington. Her specialty lies with chinks and chaps and teaching others how to build a pair going from a 3D person to a flat table. She owns Julie Baugher Leather Design in Ellensburg.

---



### Robert Beard

owns Pro Series Tool Company in Farmington, New Mexico, where he specializes in designing and crafting custom leather tools. He is a world-renowned carver, instructor and tool maker and has been a leather artist for over forty years. He was awarded the Al Stohlman Award for Achievement in Leathercraft in 1987.

---



### Tony Bernier

loves to create, everything from art, to meaningful conversation. He has a passion for life, and adores his wife and children. He's been doing upholstery for almost twenty years, and leatherwork for seven. He went to college for graphic arts, and has been building, making, and creating art for as long as he can remember. He made a point to mention how blessed he feels that he not only gets to do what he loves, but that he has the opportunity to share it with others.

---



### Bob Brenner

Besides being a full-time saddle maker, Bob was a branch bank manager that gives him good experience in reading and analyzing profit and loss statements. He was also an account manager for a computer company that did all the data processing for area banks. Based on his wealth of knowledge gleaned from these experiences, he published a book on pricing saddles and other leather work. Bob owns Pike's Peak Saddlery in Black Forest, CO.

---



### Chuck Dorsett

has been a hobbyist and professional leathercrafter for more than 30 years and produces the videos and online tutorials for Weaver Leather Craft Supply. His work has been in a number of movies including *Pirates of the Caribbean*, *Just Visiting*, *Mortal Kombat* and multiple stage and theatrical productions.

---



### Don Gonzales

became interested in leathercraft while in 8th grade, when a friend's father shared some simple skills with him. He went from making sheaths and belts and saddle repairs to eventually owning his own shop and going full-time in 2004. He credits Jimmy Plantt for many life lessons and skills learned, in addition to those from his many online friends. In October of 2020, Don launched a new, weekly podcast, *Lost Trade*. Don lives in Moulton, Texas.



## INSTRUCTORS



### Al Gould

is a custom saddle maker and leather artist, having made saddles since 1960. Horses and cattle have been a large part of his life with experience in – and not limited to – high country packing mules and cow punching. Al is also a gold card member of Pro-Rodeo. Al has taught a variety of workshops at numerous past shows and enjoys sharing as much of his hard-earned knowledge as possible. He was awarded the Al Stohman Award for Achievement in Leathercraft in 2009.



### Aaron Heizer

has been working with leather since 2001. While in the Army, he found that it was a hobby he could take with him to most places. Aaron now owns Maker's Leather Supply in Elm Mott, Texas, offering a continuously growing inventory of leatherworking tools, templates, colors, and other supplies on his website and through his retail storefront. Aaron enjoys answering all manner of leatherworking questions during his "Ask Away Monday" sessions on Facebook.



### Barry King

From his first leather project as a third grader to an artist in his own right, Barry King has remained true to the Sheridan style of carving. Though the majority of his time is spent developing and perfecting tools to carve and stamp leather, Barry, the 1994 Ann Stohman Youth Award recipient and owner of Barry King Tools in Sheridan, Wyo-ning, still finds time to put his own leather tools to work.



### Bob Klenda

has been carving leather since 1959 and making saddles since 1962. As past president and founding member of the CSMA, he is accustomed to teaching saddle making and leather carving. Bob is primarily self-taught and is eager to share his knowledge with others. He is a recipient of the Howard Munsell Award for promotion of the art of saddle making, and in 2010 he received the Al Stohman Award for Achievement in Leathercraft.



### Serina Lee

began playing with leather in 2009. In 2015 she attended her first trade show in Prescott, AZ (the Southwest Leather Workers Trade Show) and took every single workshop that time would allow for! That show, the workshops, and instructors changed her whole leather life! Serina continues to grow and learn by taking workshops and teaching whenever she can. Serina lives on her small farm/ranch with her husband of over 35 years, their horses, dogs, chickens, and a cat!



### Annie Libertini

began working with leather while in art school getting a degree in painting. Her leather masks and other work have been featured on television for Once Upon a Time, Z Nation, and Gotham, as well as in many photo shoots and theater productions all over the world.



### Michael Magnus

is a marketing consultant and professor who has helped promote some of the biggest names in the leather industry.

## INSTRUCTORS



### Clay Miller

Clay Miller grew up around racehorses, planning to become a racehorse trainer. He started doing leatherwork as a way to fill the downtime and make a little side money. During a break between race meets, he was offered a job at the local Tandy, which changed everything. He worked for Tandy, managing stores in several locations. In 2010, he moved to Texas and began to make tools and do contract leather tooling for several large leather holster and saddle shops. Soon, the tool making took off and he has been making tools full time.



### Bob Park

is a leathersmith specializing in western floral tooling. He has won numerous awards at national shows and exhibitions. In 2015, he was awarded the AI Stohlman Award for Achievement in Leathercraft. In addition to his leatherwork, Bobby is the author of *Creating Western Floral Designs*. Bobby also produces a variety of innovative products designed to improve and enhance leather working for novices and professionals alike.



### Greg Sartor

Greg Sartor, President and founder of Silver Creek Leather Co., has been involved in leather working since he was young. What started as a hobby transformed into a full time career centered around a craft that he loves. His mission for Silver Creek Leather is to continue to grow the leather craft industry by bringing leather products to general craft stores under the Realeather product line. An avid instructor, Greg enjoys teaching workshops and classes to spread the techniques of leather craft.



### John Sedberry

is retired from a career in the insurance business, having owned his own agency, and during which he did leather work off and on. In his retirement he has been able to realize a long-held desire to devote himself to his leather work. His studio/shop is located in the mountains of eastern San Diego County in California. John is a contributing author to the *Leather Crafters & Saddlers Journal*.



### Lisa Sorrell

is a bespoke cowboy boot maker in Oklahoma, known for her colorful boots and intricate designs. In addition, Lisa also sells lasts, leather, tools, and supplies for boot and shoemakers through her other business, Sorrell Notions & Findings. Her passion is preserving and promoting the historic craft of the cowboy boot.



### Takeshi Yonezawa

Takeshi 'Yone' Yonezawa started leatherwork nearly 20 years ago in Tokyo, Japan. In a world of speed and consumption, Yone invests his passion, love and time into his work, creating with the intent to change the perception and standards of quality leather goods, with countless hours of effort and thought spent going the extra mile to combine flawless execution, balanced form and function, and beautiful design. He lives in Beaverton, Oregon, with his wife, son, and dog.



### Cancellation Policy

- If you cannot attend your workshop(s) due to sudden illness, workshop registration fees will be refunded in full if canceled by July 31, 2021. After July 31, a credit will be applied to your account.
- Should workshops be cancelled by *Leather Crafters & Saddlers Journal*, all registrants in those workshops will receive automatically a full refund of the registration fee(s).

*It is our goal to provide a safe, fun, and relaxed learning environment at our shows, while following protocols for the proper and acceptable sharing and use of information gleaned while attending.*

# WORKSHOP REGISTRATION FORM

**X**

WORKSHOP	INSTRUCTOR	PG	DAY(S)	TIMES	PRICE
Airbrushing Dye on Leather	Sedberry	17	WED	9 am - 5 pm	\$280
Bobby Park's Advanced Floral Tooling	Park	17	WED	9 am - 4 pm	\$165
Bobby Park's Antiquing, Dyeing & Finishing Demo.	Park	18	TUE	7 pm - 10 pm	\$85
Bobby Park's Burnishing Edges Demonstration	Park	18	THU	9 am - 12 pm	\$85
Bobby Park's Creating Western Floral Designs	Park	19	TUE	9 am - 4 pm	\$165
Bobby Park's Inlays & Filligree	Park	19	THU	1 pm - 4 pm	\$85
Bobby Park's Sharpening Your Bench Tools	Park	20	WED	7 pm - 10 pm	\$85
Chap & Chink Making: An Overview	Klenda	20	FRI	7 pm - 9:30 pm	\$85
Chinks 101	Baugher	22	TUE	1 pm - 5 pm	\$175
Chinks 102	Baugher	22	WED	1 pm - 5 pm	\$175
Common & Creative Closures	Dorsett	22	FRI	1 pm - 5 pm	\$85
Cowboy Cuffs	Klenda	24	THU	8 am - 5 pm	\$175
DIY Marketing: Sell More Stuff	Magnus	24	FRI	7 pm - 10 pm	\$85
Fine Assembly Work	Yonezawa	25	FRI	8 am - 5 pm	\$185
Fitting & Choosing a Last	Sorrell	25	FRI	8 am - 12 pm	\$120
Floral Pattern Layout	Gould	28	SAT	8 am - 12 pm	\$85
Leather FUNdamentals	Lee	28	THU	9 am - 5 pm	\$165
Leather Tree Diorama	Bernier	28	FRI-SAT	9 am - 5 pm	\$250
Leatherwork Personal Training	Klenda	30	SAT	1 pm or 3 pm	\$100
Let's Make Saddle Bags!	Klenda	30	TUE-WED	8 am - 5 pm	\$345
Modifying Your Old Stamps	Miller	30	WED	7 pm - 10 pm	\$85
Precision Stamping with Barry King	King	31	THU	8 am - 12 pm	\$95
Pricing Your Work	Brenner	31	SAT	8 am - 12 pm	\$95
Repeating (Belt) Design	Gonzales	32	THU	9 am - 3 pm	\$165
Roll the Dice!	Lee	32	SAT	9 am - 5 pm	\$185
Saddle Solutions: All 4 Saddle Workshops	Gould	34	THU-FRI	8 am - 5 pm	\$400
Saddles - Part 1: Ground Seat	Gould	34	THU	8 am - 12 pm	\$125
Saddles - Part 2: Saddle Fit Up	Gould	34	THU	1 pm - 5 pm	\$125
Saddles - Part 3: Front	Gould	35	FRI	8 am - 12 pm	\$125
Saddles - Part 4: Cante Binding	Gould	35	FRI	1 pm - 5 pm	\$125
Sculpted 3-D Magnolia	Libertini	35	FRI	9 am - 5 pm	\$165
Shotgun Chaps Pattern Drafting	Baugher	37	THU	1 pm - 5 pm	\$175
Silver Creek Leather's Intro. to Leathercraft for Youths	Sartor	37	SAT	9 am - 12 pm	Free
Silver Creek Leather's Workshop for Veterans	Sartor	37	SUN	9 am - 12 pm	Free
Slickbald & Beard's Framed Picture (Combo)	Andre/Beard	38	WED-THU	8 am - 5 pm	\$300
Slickbald & Beard's Framed Picture (Day 1 only)	Andre	38	WED	8 am - 5 pm	\$165
Slickbald & Beard's Framed Picture (Day 2 only)	Beard	39	THU	9 am - 5 pm	\$165
Slickbald's Advanced Carving Techniques	Andre	39	THU	8 am - 5 pm	\$165
Slickbald's Belt Basics	Andre	40	WED	7 pm - 10 pm	\$85
Slickbald's Concealed Carry Gunleather	Andre	40	FRI	8 am - 5 pm	\$200
Slickbald's Cowboy Action Gunleather	Andre	41	SAT	8 am - 5 pm	\$200

**X**

WORKSHOP	INSTRUCTOR	PG	DAY(S)	TIMES	PRICE
Slickbald's Demystifying the Stitcher	Andre	41	SUN	8 am - 11 am	\$85
Swivel Knife Finesse	Gould	42	SAT	1 pm - 5 pm	\$95
The "Sarge" (Tuesday)	Heizer	42	TUE	8 am - 5 pm	\$250
The "Sarge" (Wednesday)	Heizer	43	WED	8 am - 5 pm	\$250
Tooling Realistic Portraits: Sitting Bull	Libertini	43	SAT	9 am - 5 pm	\$165
PLEASE TOTAL YOUR ENTRIES FROM PAGES 51 & 52 HERE			<b>Total \$</b>		

Student  
Name

---

Company

---

Address

---

City

---

State/Prov.

Postal Code

---

Country

---

Phone

---

Email

---

Credit Card

---

Exp

CVV

---

**PLEASE FILL OUT FORM COMPLETELY AND SEND WITH PAYMENT TO:**

Payment Methods: Check, Money Order, Visa, MasterCard, American Express, or Discover.  
All funds in U.S. dollars, payable through a U.S. bank.

**LEATHER CRAFTERS**  
& SADDLERS JOURNAL

PO Box 673 Rhinelander, WI 54501  
Tel: 715-362-5393 • Fax: 715-362-5391  
info@leathercraftersjournal.com